



Project Update and Field Activity Report

I-495 Express Lanes Northern Extension (495 NEXT) Project

Issue 5 | May 11, 2022

In This Issue...

- Project Update Meetings on June 6 and 7
- Upcoming construction activities and traffic changes
- Current field work
- New interactive map with the most recent project plans

Project Update Meetings on June 6 and 7

The Virginia Department of Transportation (VDOT), along with project partner, Transurban, and contractor, Lane Construction, will host two project update meetings on June 6 and 7 to provide residents and travelers an overview of project construction and design updates. The meetings will include a virtual and in-person option, and will include a presentation, followed by a question and answer session. Project representatives from VDOT and its partners will be present at the meetings to answer questions and address comments.

Meeting Details

In-Person Meeting

Monday, June 6, 6:30 to 8:30 p.m. (presentation at 7 p.m.)
Langley High School Auditorium
6520 Georgetown Pike, McLean VA 22101

Virtual Meeting

Tuesday, June 7, 6:30 to 8:30 p.m. (presentation at 6:30 p.m.)
Visit [495NEXT.org/public_meetings](https://www.495next.org/public_meetings) for details on how to join the meeting

The project update meetings will focus on:

- Upcoming construction activities, including a preliminary timeline
- Expected construction impacts
- Project design changes and enhancements
- New interactive map showing latest construction, designs and plans
- Coordination with the adjacent George Washington Memorial Parkway rehabilitation project and the New American Legion Bridge I-270 Traffic Relief Plan

Upcoming Construction

Permanent Closure of Left Shoulder Lane and Reconfiguration of Beltway Lanes

To accommodate upcoming construction work, the northbound left shoulder (green arrow/red X) lane, which is open during morning and afternoon peak travel periods from where the current 495 Express Lanes end to the George Washington Memorial Parkway, will close permanently to accommodate upcoming construction. This work is planned to begin as early as May 31.

This section of I-495 will be restriped to maintain four lanes in each direction and to make space in the center of the Beltway for construction of center bridge piers at Old Dominion Drive, Georgetown Pike and Live Oak Drive. Temporary barriers will be placed to secure the center work zone for the safety of travelers and workers.

Prior to closing the left shoulder lane, the traveling public will be notified via electronic signs, a news release, social media and other means. Periodic lane closures are required to complete this work. Closures will be limited to non-peak travel hours.

New Traffic Pattern – I-495 Northbound (Old Dominion Drive to Live Oak Drive)

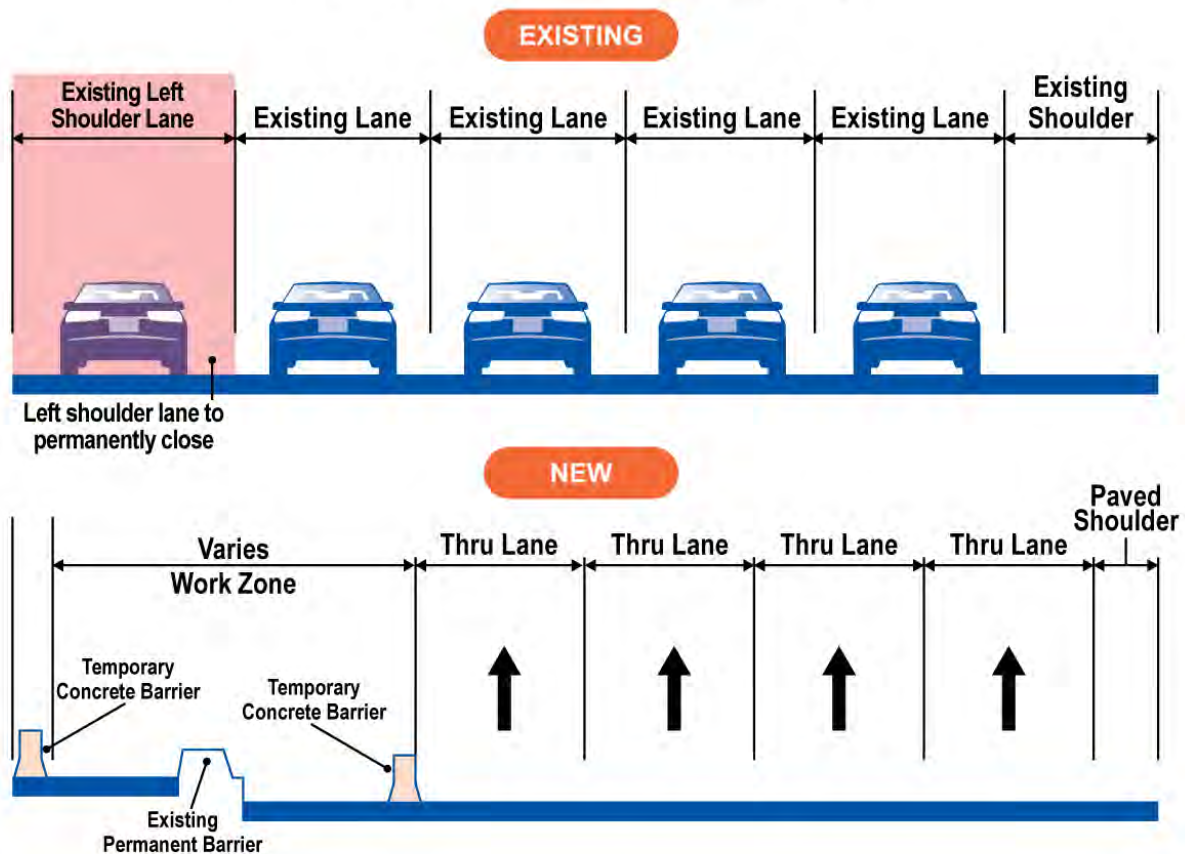

Georgetown Pike Bridge

Planned for late spring or early summer, the center median of the Georgetown Pike bridge over I-495 will be demolished and a temporary traffic barrier will be installed along the westbound shoulder. East- and westbound traffic will be shifted slightly south on the existing bridge to prepare for demolition of the northern portion of the bridge and

temporary traffic signals will be installed.

The work will occur during day- and nighttime hours, and will require lane closures during non-peak travel periods.

All field work is subject to change based on weather and other factors.

Current Field Activities

Test Borings

Geotechnical test borings continue and are anticipated to be completed by early summer. The majority of borings on VDOT right-of-way adjacent to residences have been completed. The boring operations along I-495 require single-lane closures during daytime off-peak hours to provide a safety buffer between work crews and traffic.



New Interactive Map and Website Refresh

A new interactive map has been added to the [495 NEXT website](#) providing details on the full range of project features, such as the new express lanes and associated access ramps, environmental features, the new bicycle pedestrian trail, and much more. The map also allows users to select project elements and features they wish to see in detail, such as right-of-way lines, proposed noise barrier locations and other features. Additionally, the [495 NEXT website](#) continues to be refreshed with new and updated content to reflect the project's transition to design and construction.

The image shows a screenshot of the "495 ExpressLanes Interactive Map" website. The top left corner features the "495 ExpressLanes" logo with "NORTHERN EXTENSION" underneath. Below the logo is a search bar with the text "Find address or place" and a magnifying glass icon. To the left of the search bar are navigation icons: a plus sign, a minus sign, a home icon, and a refresh icon. The main map area displays an aerial view of the project site with various colored overlays representing different project features. A scale bar at the bottom left indicates "300ft". The map shows several lanes of traffic, ramps, and bridges. A road labeled "Balls Hill Rd" is visible at the bottom. On the right side, there is a "Legend" panel with a blue header and a close button. The legend is titled "Descriptions of Project Features" and lists several categories: "Lanes and Pavement Markers" (represented by an orange circle), "Project Features" (including Bridges, Cross Roads, Express Lanes, General Lanes, Ramp, Shared Use Path, and Sidewalk), and "Adjoining Parcels" (represented by a purple line).

Project Background

The 495 Express Lanes Northern Extension project (495 NEXT) is extending the existing 495 Express Lanes north by two-and-a-half miles from the Dulles Corridor interchange to the George Washington Memorial Parkway interchange in the vicinity of the American Legion Bridge. The project will provide new and improved connections at the Dulles Corridor and George Washington Memorial Parkway.

Other project benefits include four miles of new bicycle and pedestrian connections including a shared-use path parallel to I-495 from Lewinsville Road to near Live Oak Drive, replacement or rehabilitation of seven bridges with pedestrian accommodations, replacement of nine existing noise walls and construction of a new noise wall along Live Oak Drive in the vicinity of the George Washington Memorial Parkway interchange, environmental improvements introducing stormwater management facilities and funding restoration of the stream at Scotts Run, and dedicated funding to support transit improvements in the corridor including new bus service over the American Legion Bridge.

495 NEXT is a public-private partnership project between the Commonwealth of Virginia and Transurban, operator of the existing 495 Express Lanes. Lane Construction is the design-build contractor for the project. The new extended lanes are scheduled to open in 2025.



Learn More About the Project

Check out www.495NEXT.org for additional information.

[Sign up](#) here to receive project email updates.



Questions?

Visit: www.495NEXT.org

Email: 495NorthernExtension@vdot.virginia.gov

Call: Virginia Department of Transportation, Michelle Holland, 703-586-0487

Transurban, Brent McKenzie, 571-326-5609 | Lane Construction, John Undeland, 703-785-3461



Virginia Department of Transportation | 4975 Alliance Drive, Fairfax, VA 22030

[Unsubscribe michelle.holland@vdot.virginia.gov](mailto:michelle.holland@vdot.virginia.gov)

[Update Profile](#) | [Constant Contact Data Notice](#)

Sent by michelle.holland@vdot.virginia.gov in collaboration
with



Try email marketing for free today!